

# EN MOUNTING INSTRUCTIONS

The technical data are mentioned on the label of the lighting fixture.  
(ambient temperature, IP degree, etc.)

Typ	A(mm)	B(mm)	C(mm)	Montážní otvory Ø6,3mm Mounting hole size Ø6,3mm
GALGO-LED-1250-118-4K	690	198	108	340
GALGO-LED-2500/5000-218-4K	690	198	108	340
GALGO-LED-2500-136-4K	1300	198	108	350X350
GALGO-LED-5000/10000-236-4K	1300	198	108	350X350
GALGO-LED-3750-158-4K	1600	198	108	350X350X350
GALGO-LED-7500/12550-258-4K	1600	198 <td 108	350X350X350	
GALGO-LED-FF-1250-118-4K	696	198	108	340
GALGO-LED-FF-2500/5000-218-4K	696	198	108	340
GALGO-LED-FF-2500-136-4K	1306	198	108	350X350
GALGO-LED-FF-5000/10000-236-4K	1306	198	108	350X350
GALGO-LED-FF-3750-158-4K	1606	198	108	350X350X350
GALGO-LED-FF-7500/12550-258-4K	1606	198	108	350X350X350

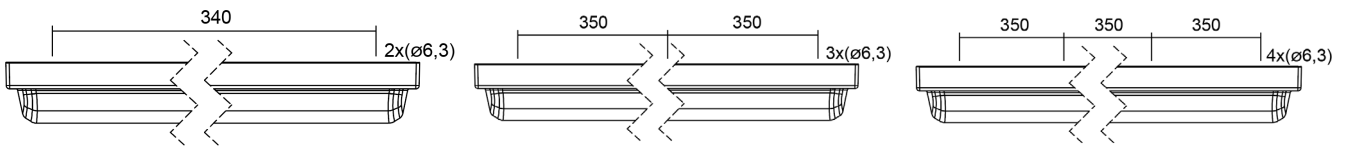
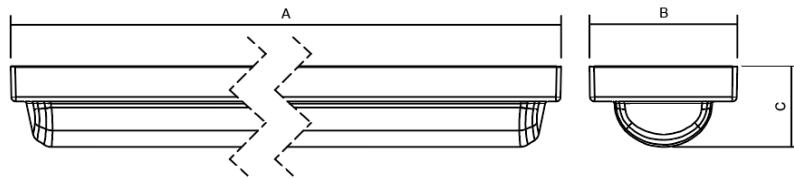

## SALGO-LED MULTISALGO-LED

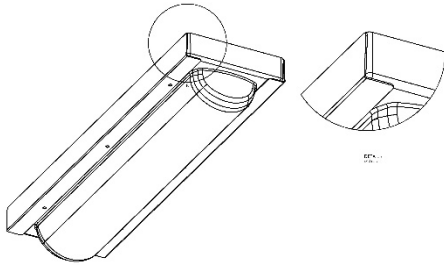

## SALGO-LED-FF MULTISALGO-LED-FF

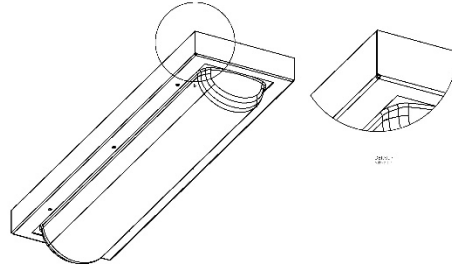

### Warning for mounting lighting fixture SALGO-LED

**When installing lighting fixture, observe the ESD safety using appropriate tools!**



/GB/ Producer included ion recycling system provided by EKO-KOM company. (EK-F06022453)

/EN/ The lighting fixture can be installed by authorized persons only according to valid regulations on professional qualifications in electrical engineering. Failure to comply with manufacturer's installation instructions not liable for any damages!

/EN/ Construction of the lighting fixture doesn't need special maintenance. Wash the polluted housing with the cool water and detergent.

/EN/ The battery in the fixture can be changed for the same type or the same parameters only !!

/EN/ In case of instruction non-performance producer can not be responsible for relevant damages caused !

**Mounting instruction:**

1. Take the lighting fixture from packing.
2. Unbolt the screws from the cover of the fixture and take it down. (fig. 1)
3. Loosen the screws and remove the reflector from lighting fixture. (fig. 2)
4. Lead supply cable through cable gland. (fig. 3)
5. Install the fixture on the ceiling or wall (use a screw with a diameter of 6mm and tightening torque 3Nm - fig. 4)  
At a wall installation, place lighting fixture so that LED driver was down. (fig. 7)  
note: The luminaire is not suitable for installation in plasterboard.
6. Connect supply cable into the free feeding terminal block as follows:

**SALGO-LED**

on connector L -phase conductor  
 on connector N -neutral conductor  
 on connector □ -protective conductor

**MULTISALGO-LED**

on connector L1 -conductor of charging phase  
 on connector L2 -conductor of switching phase  
 on connector N -neutral conductor  
 on connector □□ □□□□□□□□ -protective conductor

On each pole of terminal block can be connected two conductors in cut 0,5-2,5mm<sup>2</sup>.

Stripping length must be 8-9 mm.

7. Fix reflector back into housing and tighten the screws. (fig. 5)
8. Fasten the optical cover and fix by means of screws (use tightening torque 0,8Nm). (fig. 6)

Fig. 1

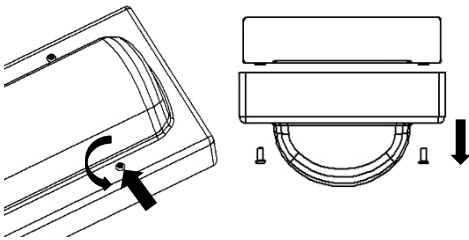

Fig. 2

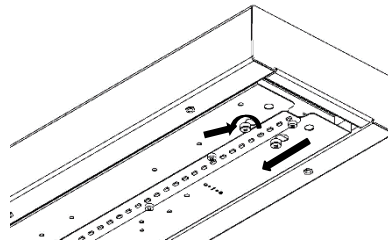

Fig. 3

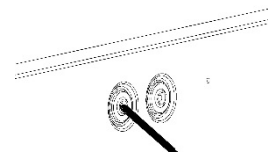

Fig. 4

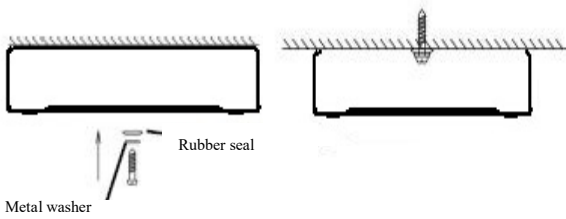

Fig. 5

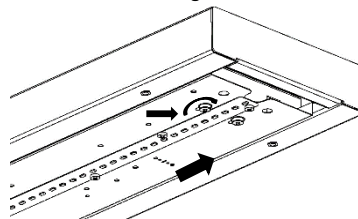

Fig. 6

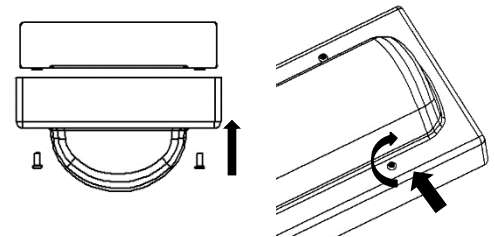

Fig. 7

**Wall installation**